

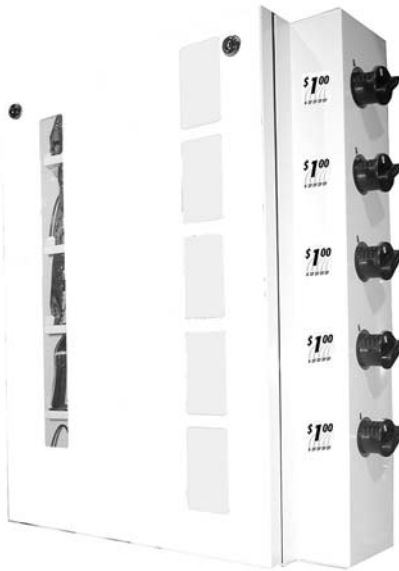

Mechanical Vendor



Operator's Manual

INTRODUCTION

Congratulations on the purchase of your new Mechanical Vendor. This vendor has been designed to give you many years of dependable service. It requires little maintenance and is easy to set up and operate.

READ THIS MANUAL COMPLETELY

Your vendor is designed to operate simply and reliably, but to take full advantage of your vendor, please read this owner's manual thoroughly. It contains important information regarding installation and operations, as well as a brief trouble-shooting guide.

EQUIPMENT INSPECTION

After you have received your vendor and have it out of the box, place it on a secure surface for further inspection. **Note:** Any damages that may have occurred during shipping must be reported to the delivery carrier immediately. Reporting damages and the seeking of restitution is the responsibility of the equipment owner. The factory is willing to assist you in this process in any way possible. Feel free to contact our Customer Care Department with any questions you may have on this process.

Once you have your vendor located, we suggest that you keep this manual for future reference, or you can view this manual online at www.seagamfg.com. Should any problems occur, refer to the section entitled "trouble-shooting guide". It is designed to help you quickly identify a problem and correct it.

MANUFACTURER'S WARRANTY

WHAT IS COVERED: Manufacturer warrants TO THE ORIGINAL PURCHASER ONLY that each item of equipment manufactured is free from defects in material and workmanship under normal use and service. Manufacturer's obligation under warranty shall be limited to repair or replacement, at our plant, of any parts of the equipment which shall within one year of the date of shipment to the original purchase, be demonstrated to be defective. The original purchaser may obtain repair or replacement of the equipment under warranty by returning the defective item or entire vendor to the Manufacturer, freight prepaid.

WHAT IS NOT COVERED: Manufacturer's warranty obligations DO NOT EXTEND TO OR INCLUDE installation expenses, vandalism, or difficulties resulting from failure to operate equipment in accordance with Manufacturer's instructions under competent supervision and difficulties due to changes in vended products, which are beyond the control of manufacturer.

SPECIAL NOTE: Manufacturer is not responsible for any loss of income due to a vending machine being out of service due to a warrantable item.

This warranty is in lieu of all the other warranties, expressed or implied, including the warranty of merchantability and fitness or use, and of all other obligations or liabilities on Manufacturer's part. Manufacturer neither assumes, nor authorizes any other person to assume for it, any other liability in connection with the sale of equipment manufactured by itself. This warranty shall not apply to equipment manufactured or any part thereof which is subject to accident, negligence, alteration, abuse, misuse, or damage in shipment. The term "original purchaser", as used in this warranty, shall be deemed to mean that person for whom the equipment is originally installed.

Manufacturer is not liable for any incidental, consequential or other damages of any kind whatsoever, directly or indirectly, arising from the use of the equipment whether based upon theories of contract negligence or tort. Effective 09/2001

For Service and Customer Care:
8:30 a.m. - 4:00 p.m. CST. Mon thru Fri
815.297.9500 ext 160
815.297.1758 Fax
email: customer care@seagamfg.com

For Service and Customer Care:
9:00 a.m. - 5:30 p.m. Mon thru Fri
+44(0)1492 874010
+44(0)1492 874644 Fax
email: info@seaga.co.uk



Seaga Manufacturing, Inc.
700 Seaga Drive
Freeport, IL 61032 U.S.A.
www.seagamfg.com

Seaga UK Ltd.
Unit 8, Caebach, Off Builders Street
Llandudno North Wales LL30 1DR
www.seaga.co.uk

IMPORTANT NOTICES

Your vendor is intended for indoor use only
Your vendor must be set on a well supported location and wall or stand (optional) mounted.
Always unload vendor before transporting it.
Remove the plastic cable ties from each helix coil.
Remove any protective sheets from under the Helix coils before loading the vendor.
Do not load your vendor with disfigured or damaged product.

Section 1

BRIEF DESCRIPTION OF YOUR VENDOR

Fig. 1

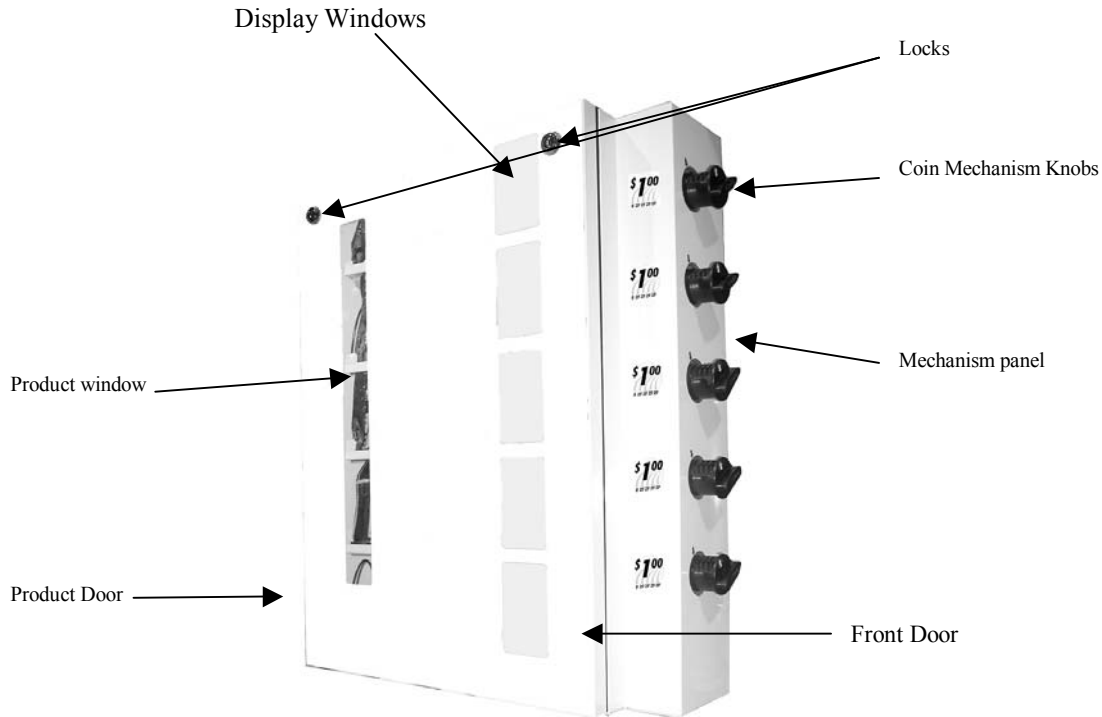

HOW TO LOCK & UNLOCK THE DOOR OF VENDOR

Your Vendor has 2 locks, one at the top left and right of the front door (Fig. 1). To open the door, insert the Key in the locks and turn one-quarter rotation clockwise for right lock and counter clock wise for left lock. The door can now be opened. The paper sheets under the helix coils and the cable ties on each helix coil must be removed before loading the vendor.

MOUNTING

Your Vendor can be wall mounted. For wall mounting, Four (4) Mounting Holes are provided on the back of the vendor. The Holes are 16" on center to mount to most wall studs. (Fig.2). A power drill, screwdriver, a small torpedo level, a ¼ " drill bit, and mounting hardware will be required. (Note: Mounting hardware is not provided)

To Wall mount:

- a.) Unlock and open the Front Door
- b.) Determine, on the wall where vendor is to be mounted and mark where the upper two (2) holes are to be located. (Fig.2)

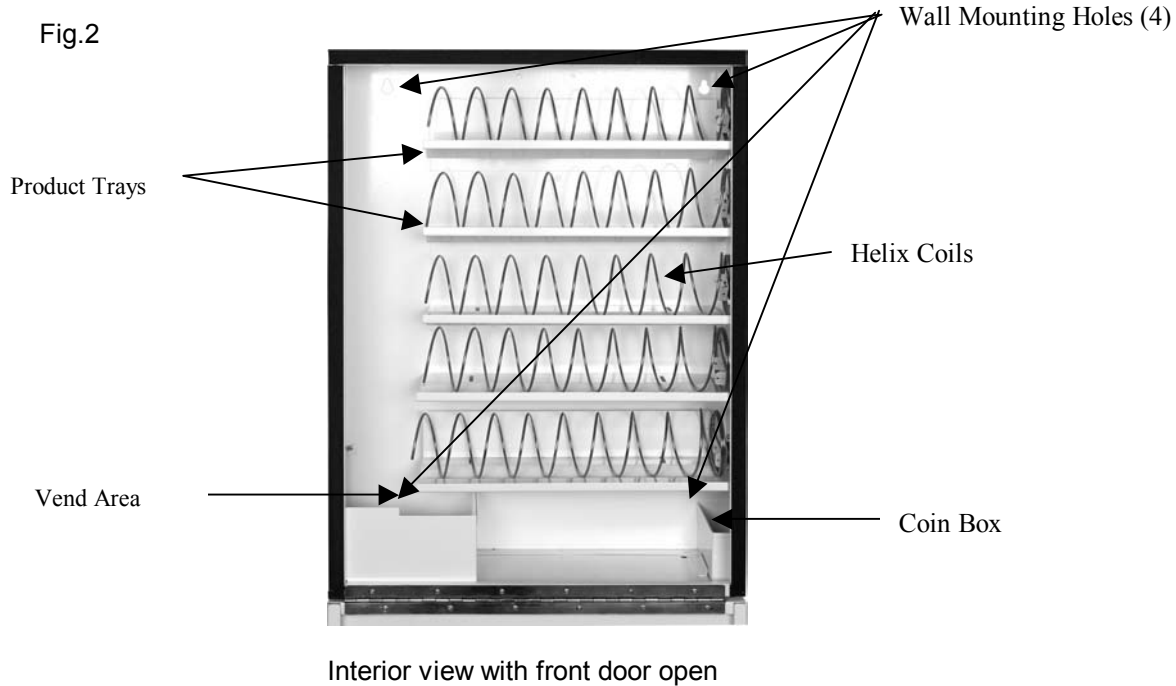

Special Note: To secure properly, vendor must be mounted to studs, and to vend properly the vendor must be level. If mounting into studs is not possible, different hardware will be necessary for a hollow wall.

- c.) Pre-drill if necessary
- d.) Once the vendor has been mounted by the top holes, the lower holes should fall in-line, but double check with the small “torpedo” level. When mounting into studs, screw through the wall Mounting Holes in the vendor into the wall. When going into hollow wall, the holes will need to be pre-marked and the anchors inserted into the wall before the vendor can be mounted

DELIVERY SYSTEM

The delivery system is made up of three components, the Product Tray, the Helix Coils, and the Coin Mechanism (Fig.3). Once the proper amount of coins is received the Coin Mechanism can be turned to drive the Helix Coils and push the product out from the left side of the Product Tray.

The product tray and the product tray back are slotted for adjustment purposes. By loosening the nuts on the product trays and tray backs, the vendor can be customized to vend a variety of products to suit your needs. (Fig. 3a).

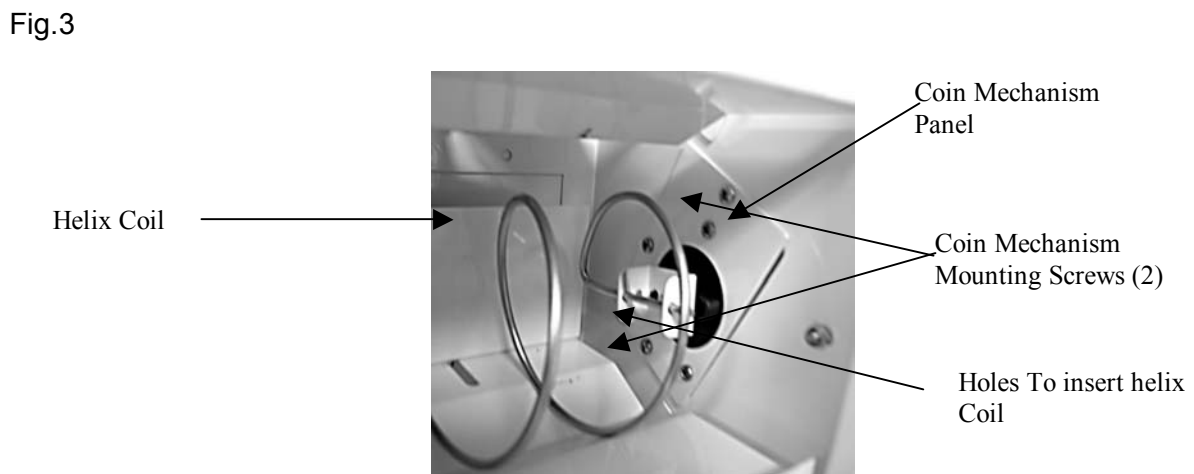

Fig. 3a



Loosening nuts will allow you to adjust the tray depth.

COIN MECHANISM

The Mechanism panel is the right hand side panel. This panel controls the receiving of money and the action of the Helix Coil. Once the correct amount of money is received, the Mechanism Knob can be pushed in and turned clockwise. Product is vended by turning the Mechanism Knob one (1) complete revolution.

The Coin Mechanisms come factory pre-set for \$1 (4 US quarters), unless you requested another setting at the time of your order. The mechanisms can be changed easily to suit your needs. The coin sub-assembly is made of a slotted black plastic cylinder into which the coin inserts and wedge are placed (Fig.4). The Black inserts are marked as per the table below.

COINS CODE LIST				
S.NO.	CODE	Coin Specifications		Remarks
		Country	Currency / Value	
1	ZZ	USA	-----	Dummy
		CANADA	-----	Dummy
		UK	-----	Dummy
2	YY	USA	NICKEL/.05 CENTS	
		CANADA	.05 CENT	
		UK	20 PENCE	
3	XX	USA	DIME/.10 CENTS	
		CANADA	.10 CENT	
		UK	-----	
4	WW	USA	QUARTER/.25 CENTS	
		CANADA	0.25 CENTS	
		UK	10 PENCE	
5	VV	USA	GOLDEN DOLLAR	
		CANADA	LOONIE - 1 CND.\$	
		UK	-----	
6	UU	USA	-----	
		CANADA	TOONIE - 2 CND. \$	
		UK	50 PENCE	
7	TT	USA	-----	
		CANADA	-----	
		UK	1 POUND	

Fig.4

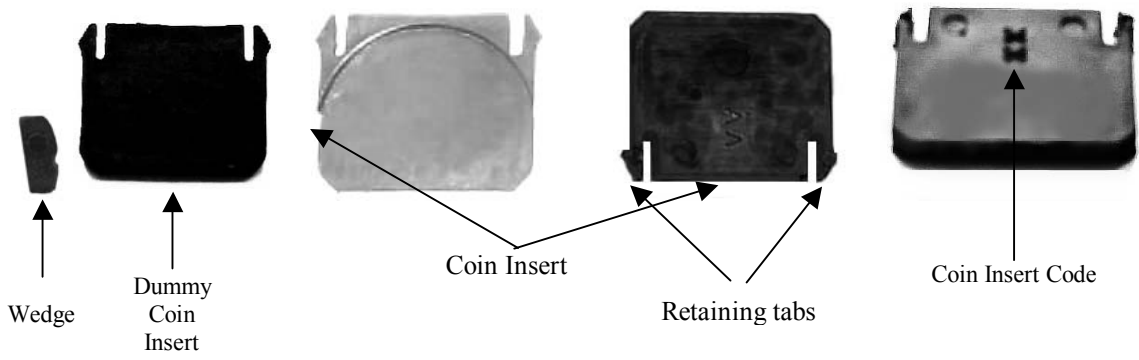

Coin Mechanism Assembly

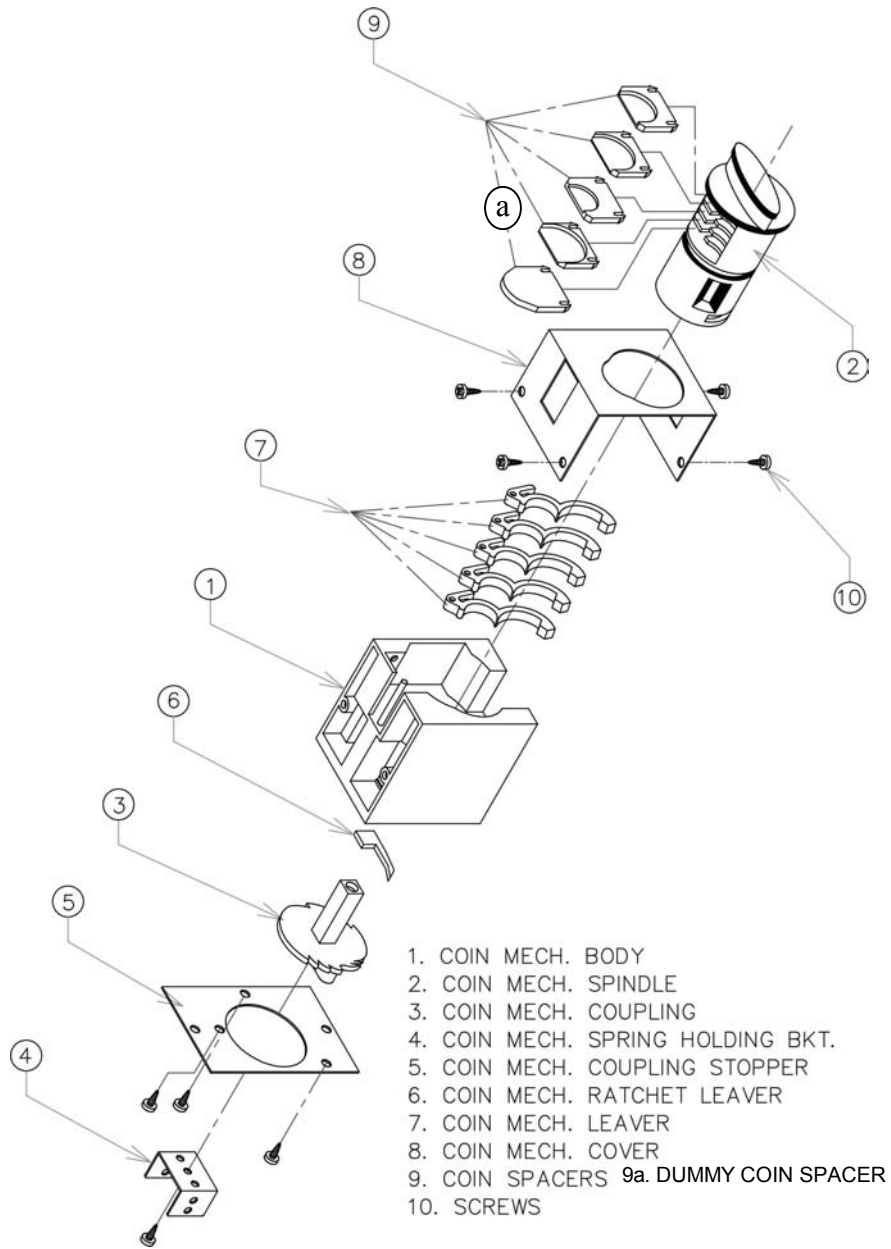

The Coin Mechanism assembly will need to be removed in order to configure the coin mechanism as with a change in price.

To remove the coin mechanism:

- 1.) Disconnect the spiral from the coin mechanism assembly by rotating the coin mech handle until the spiral end can be removed from the clip.
- 2.) Remove the two mounting screws (Fig. 3) and draw the sub-assembly through the body of the machine.

To configure the coin mechanism to suit the price of the product, relevant Discs totaling the product price can be inserted in any combination of 5 coins. Dummy inserts can be used for combination of less than 5 coins. When using the dummy inserts, a wedge (Fig. 4) will need to be inserted into the corresponding position on the top of the mechanism (Fig. 5b). It is suggested that, if dummy inserts are used, that they be inserted into the slot farthest to the right to eliminate confusion for the customer. Make sure that the discs and wedge click when inserted into the mechanism. Any or all the discs can be pulled out with a needle nosed pliers to set a new pricing. (Fig. 5).

Fig.5

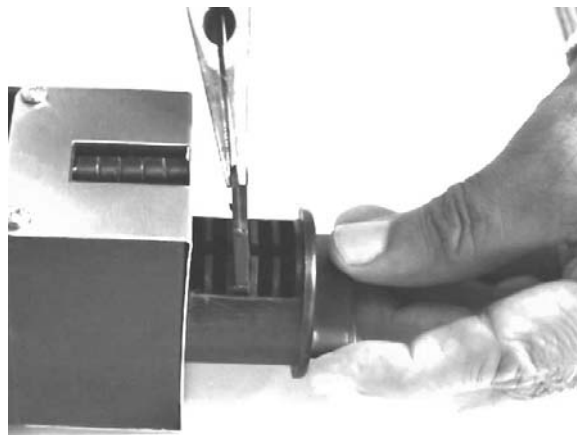
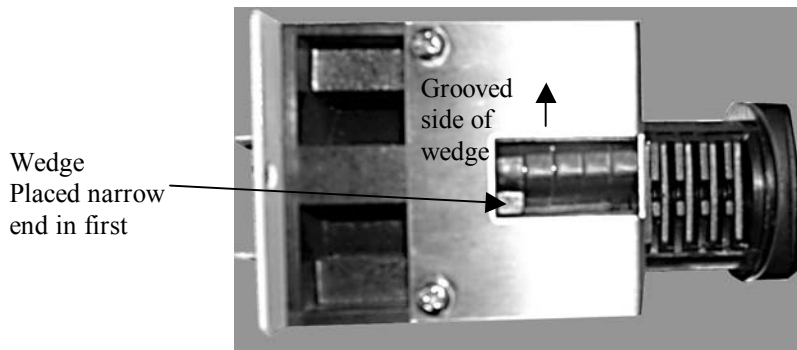

Fig.5b



LOADING PRODUCT

To present your product in as attractive and professional manner as possible, do not load damaged items.

Note: The size of the item being vended must be larger than the Helix Coil, but smaller than the coil support plate, to vend correctly. Never force an oversized item into the Helix Coil or attempt to vend an item that is smaller than the Helix Coil as this will create problems and deter customers.

1. To Load Product:

- a.) Fill all product trays; do not leave any spaces behind or between items. If you must leave space leave it on the right of the tray closest to the Coin Mechanism. (Fig.6)

Special Note: We suggest that you always partially fill the vendor with product and perform at least five (5) test vends.

Fig. 6 Loading Product



PRODUCT VIEWING AND ADVERTISEMENT

A Product Window is provided for “live” product viewing, and Display window is provided for advertisement. The full-length window is to view the product in all Product Trays. The owner may place packaging, advertisement, or graphics that would be suitable to promote the product in the smaller Display Windows.

1. To insert graphic into display window.
 - a.) Unlock and open the Front Door.
 - b.) Loosen the nuts that hold the Panel of the Display window. Remove panel.
 - c.) Tape graphic/sticker down into the appropriate Display Window.
 - d.) Reassemble

Note: Such advertisements or promotional materials are not provided by the manufacturer. We suggest that you apply a window label of your own or use empty package to best describe the particular product in that chute.

COIN RETRIEVAL

One (1) Coin Box is provided with your vendor. It is stored at the bottom of the Mechanism Panel. Once the Front Door is open pull the Coin box out to empty it.

NOTES